

II. Location plan for components and interfaces

1. Location plan for body harness and components in Fig. 4-125 (a), location plan for body earth wire and interfaces connecting the harness in Fig. 4-125 (b)

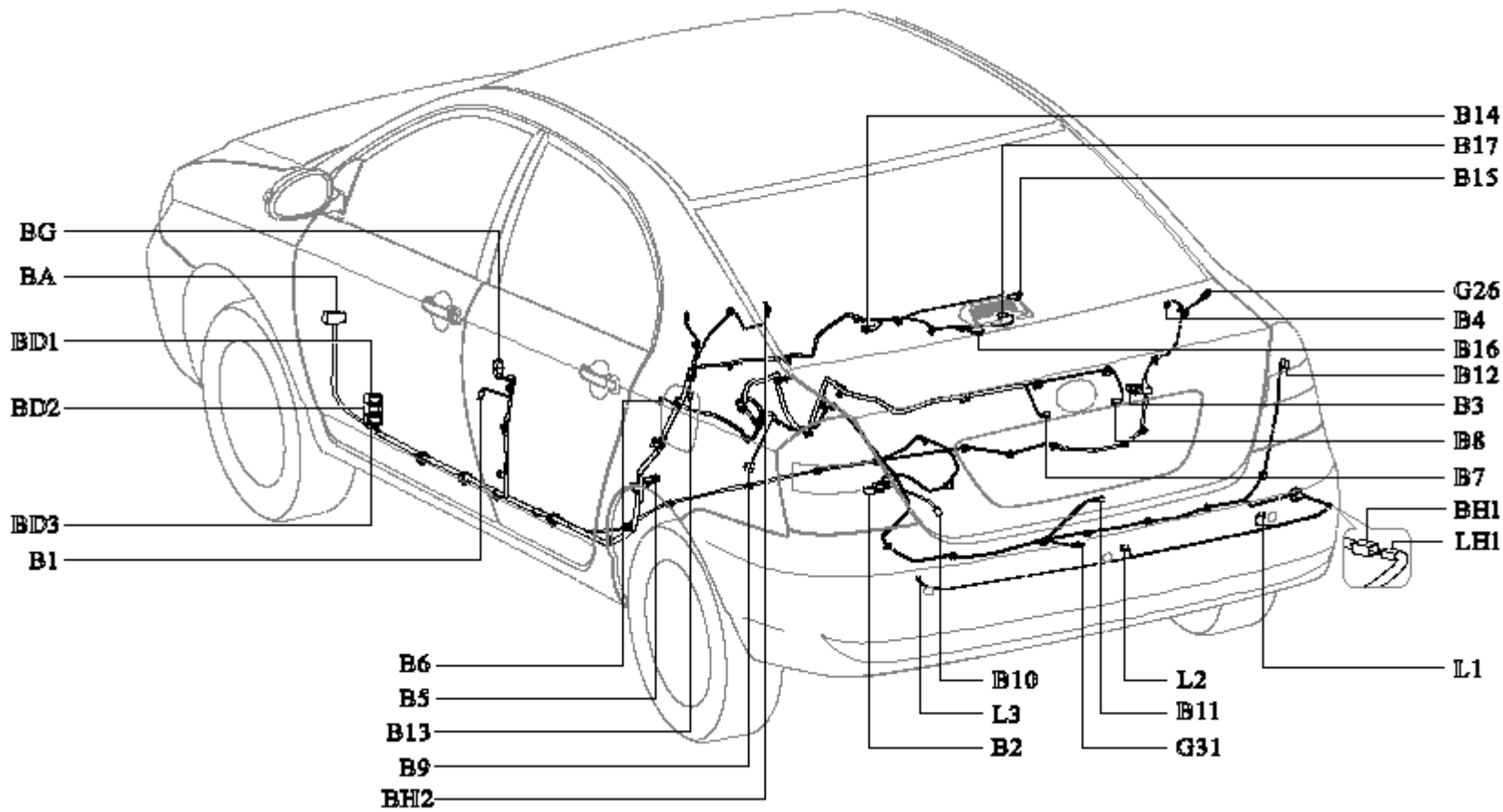

B1-connect to left front door lamp switch; B2-connect to electric fuel pump; B3-right rear wheel speed sensor harness; B4-right rear door lamp switch; B5-connect to right front door lamp switch; B6-connect to left rear door lamp switch; B7-left license plate lamp; B8-right license plate lamp; B9-burglar alarm; B10-left rear combination lamp; B11-luggage boot switch; B12-right rear combination lamp; B13-noise filter; B14-left rear speaker; B15-right rear speaker; B16-luggage boot lamp; B17-high-mounted brake lamp; BA-connect to front harness; BG-connect to left rear door small harness; RE, WJ, BD1, BD2, BD3-connect to dash board harness; G25, G26, G27, G31-body ground point; BH1-connect to reverse radar harness; BH2-rear defrosting glass; LH1-connect to left body harness; LH2-rear defrosting negative; L1-right reverse radar probe; L2-middle reverse radar probe; L3-left reverse radar probe; R1-connect to roof light; W1-connect to CD player

Fig. 4-125 (a)

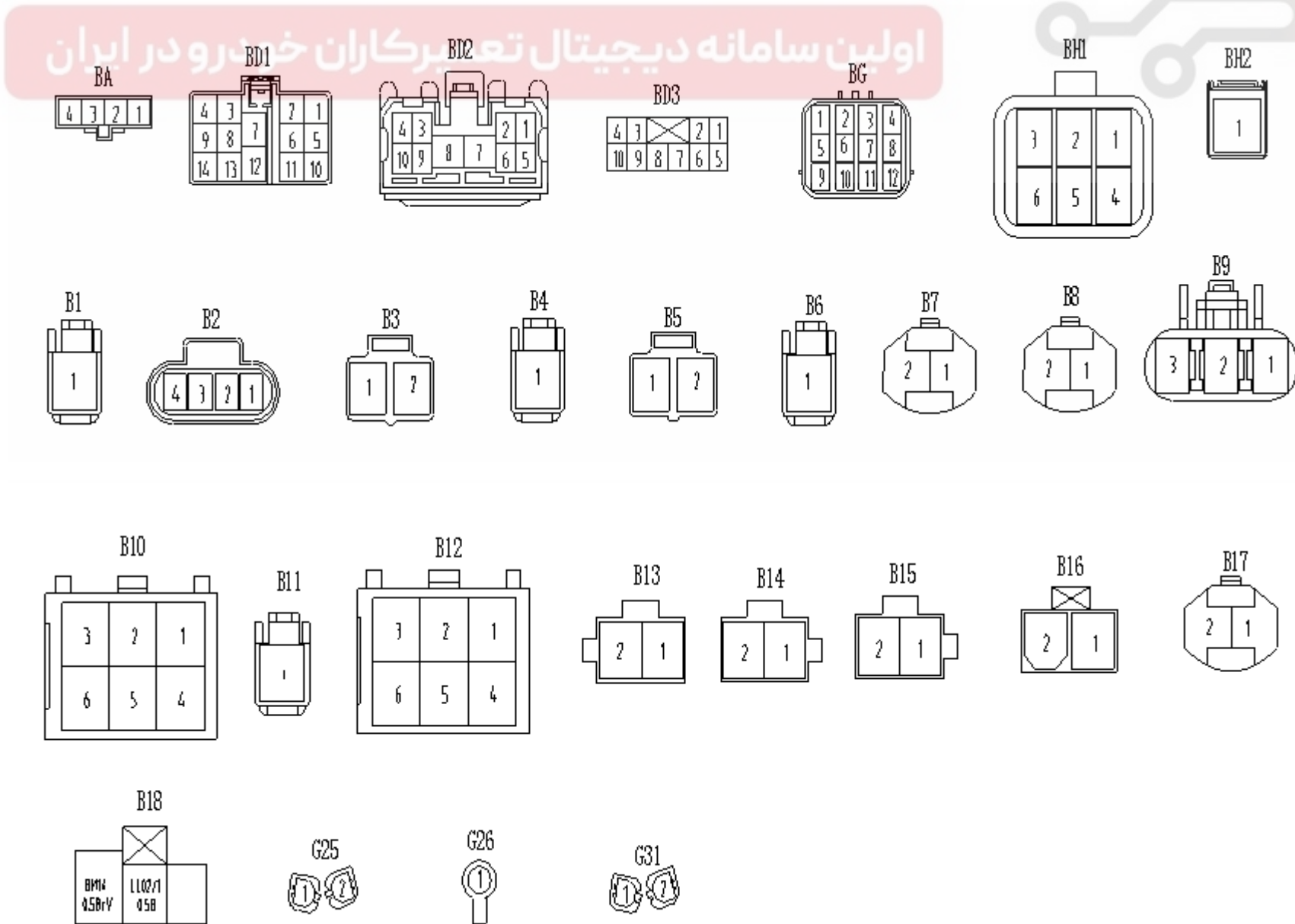
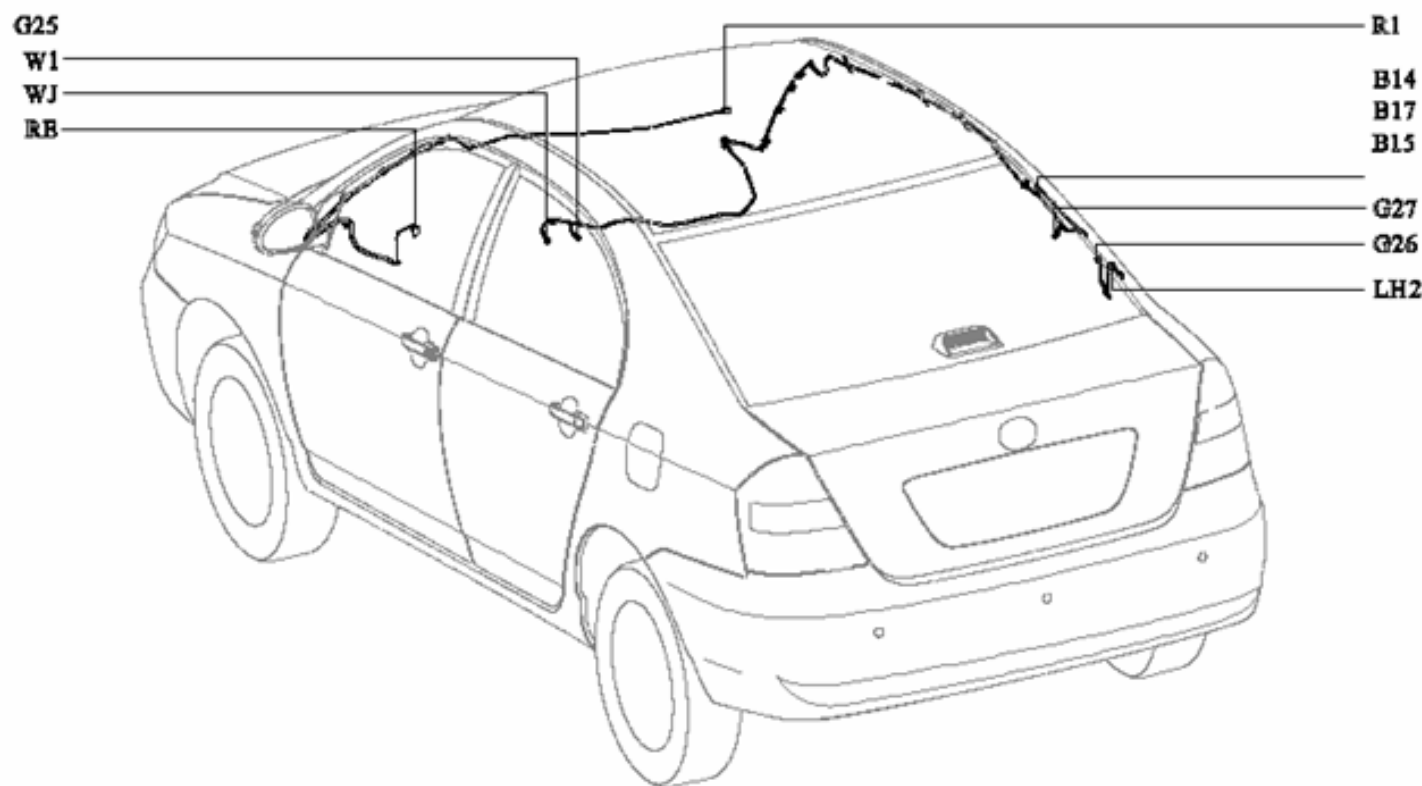

Fig. 4-125 (b)

2. Location plan for roof harness and components in Fig. 4-126



B1-connect to left front door lamp switch; B2-connect to electric fuel pump; B3-right rear wheel speed sensor harness; B4-right rear door lamp switch; B5-connect to right front door lamp switch; B6-connect to left rear door lamp switch; B7-left license plate lamp; B8-right license plate lamp; B9-burglar alarm; B10-left rear combination lamp; B11-luggage boot switch; B12-right rear combination lamp; B13-noise filter; B14-left rear speaker; B15-right rear speaker; B16-luggage boot lamp; B17-high-mounted brake lamp; BA-connect to front harness; BG-connect to left rear door small harness; RE, WJ, BD1, BD2, BD3-connect to dash board harness; G25, G26, G27, G31-body contact point; BH1-connect to reverse radar harness; BH2-rear defrosting glass; LH1-connect to left body harness; LH2-rear defrosting negative; L1-right reverse radar probe; L2-middle reverse radar probe; L3-left reverse radar probe; R1-connect to rear roof light; W1-connect to CD player

Fig. 4-126

3. Location plan for door harness and components in Fig. 4-127 (a), location plan for door earth wire and interfaces connecting the harness in Fig. 4-127 (b)

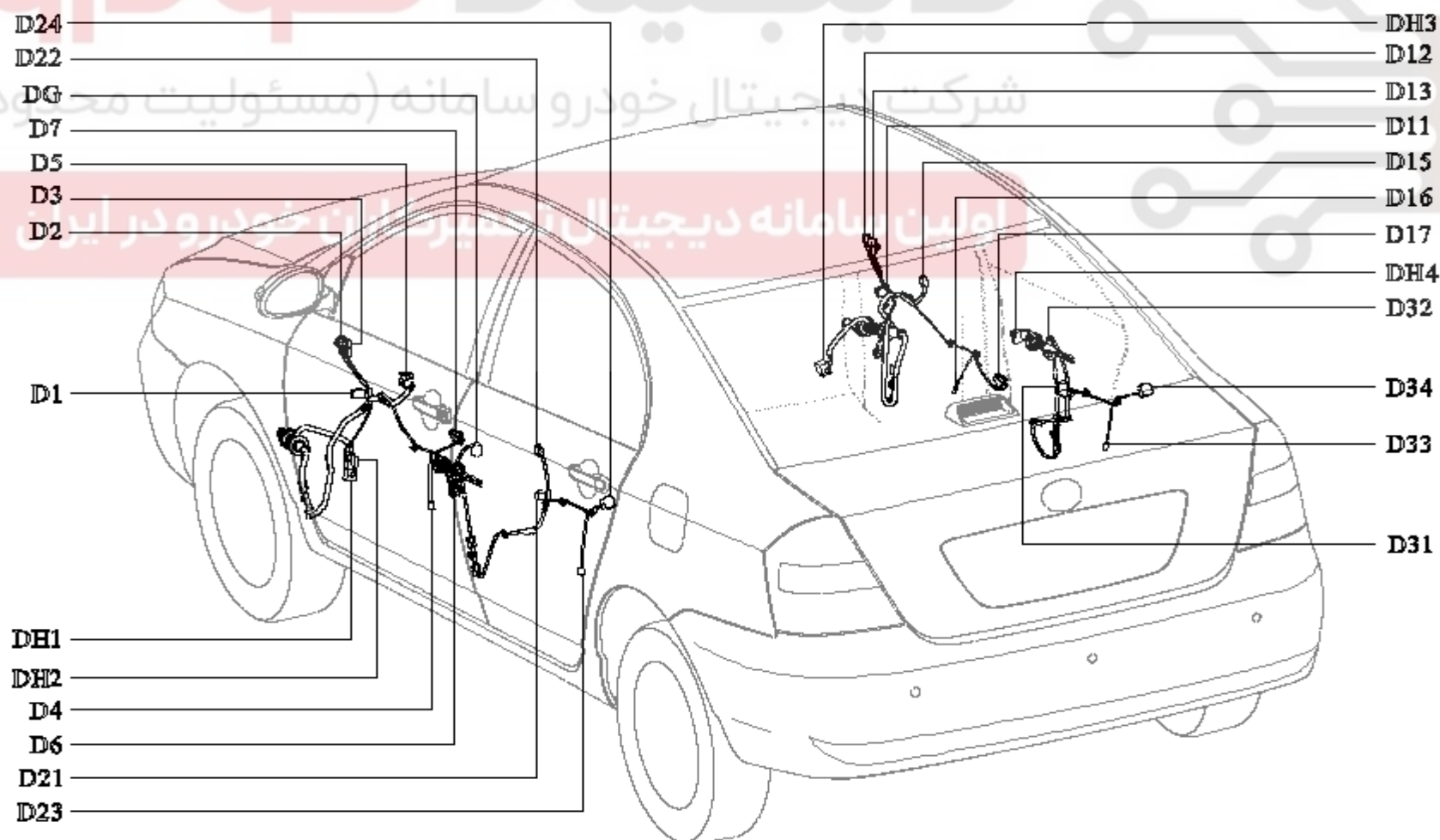

D1-left front window regulator motor; D2-left electric rearview mirror; D3-left front althorn; D4-left front door speaker; D5-left front door window regulator switch; D6-connect to left front door lamp; D7-left front door locking mechanism; D11-right front window regulator motor; D12-right electric rearview mirror; D13-right front althorn; D15-right front window regulator switch; D16-right front door lamp; D17-connect to right front door locking mechanism; D21-left rear window regulator motor; D22-left rear door window regulator switch; D23-left rear door lamp; D24-left rear door locking mechanism; D31-right rear window regulator motor; D32-right rear window regulator switch; D33-right rear door lamp; D34-right rear door locking mechanism; DH1, DH2, DH3, DH4-connect to dash board harness; DG-connect to left body harness

Fig. 4-127 (a)

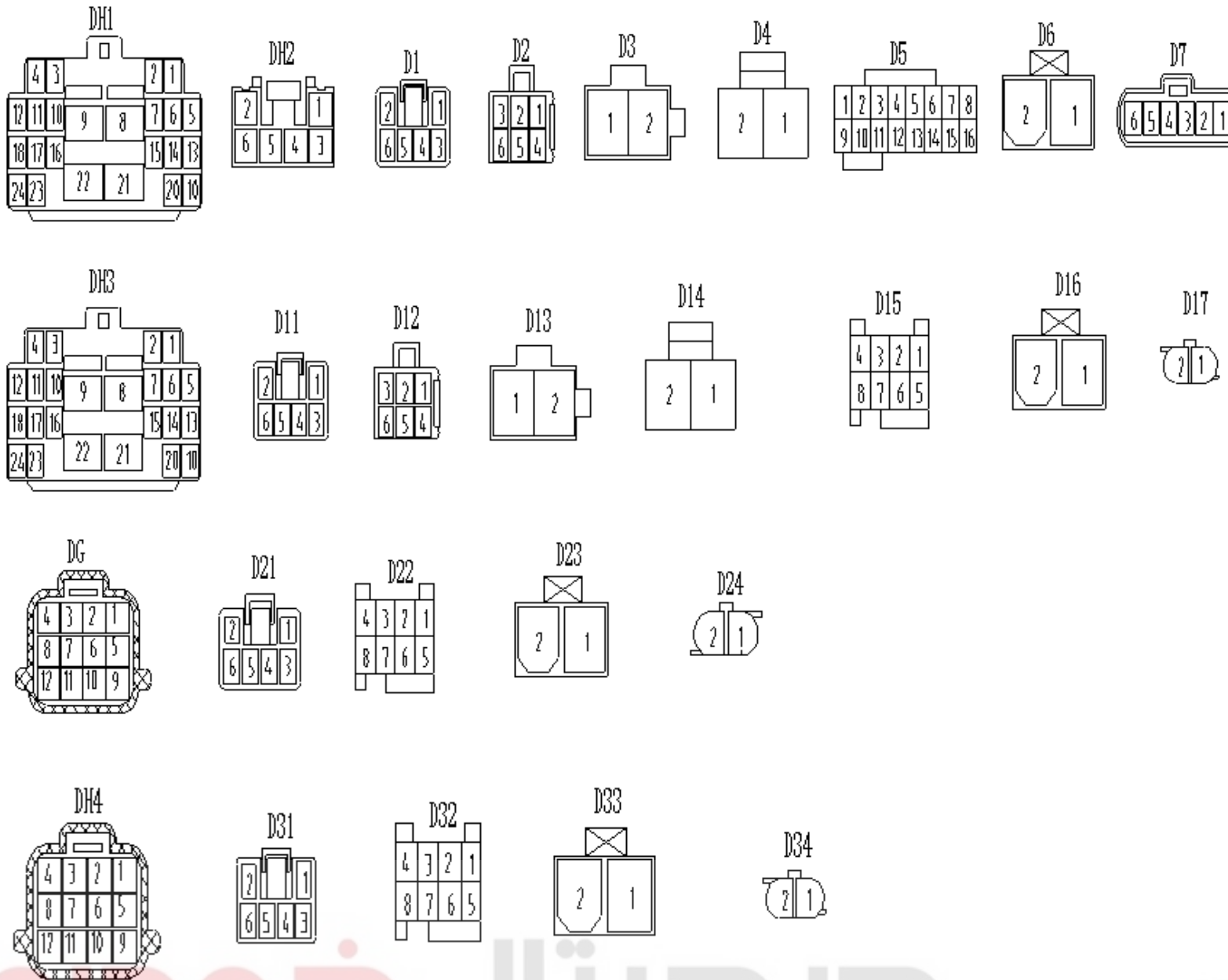
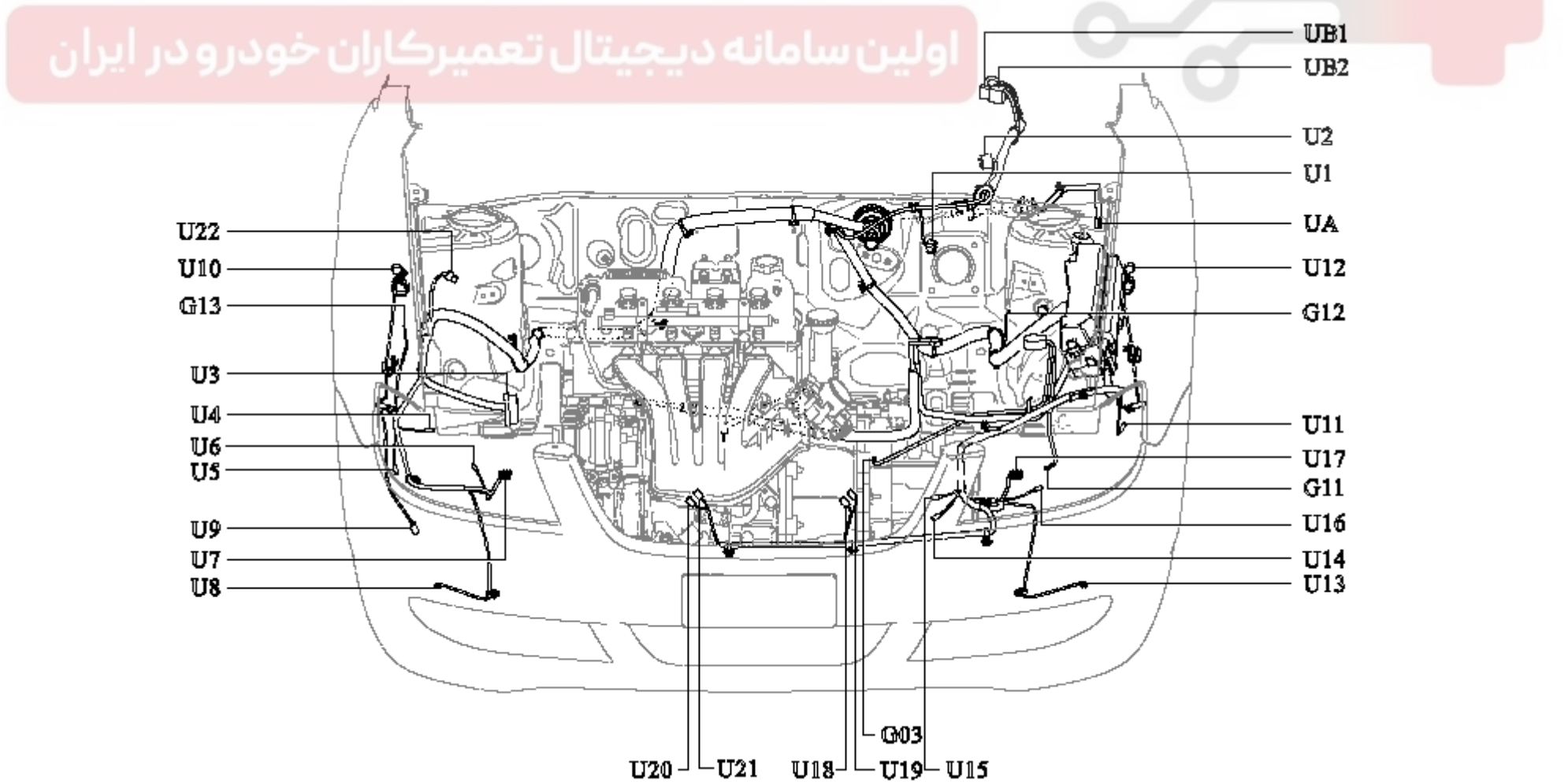

Fig. 4-127 (b)

4. Location plan for front harness and components in Fig. 4-128 (a), location plan for front compartment earth wire and interfaces connecting the harness in Fig. 4-128 (b)



U1-brake fluid level switch; U2-wiper motor; U3-ABS controller; U4-A/C high and low pressure switch; U5-right front steering light; U6-right front dimmer motor; U7-right front combination lamp; U8-right front fog light; U9-washing pump motor; U10-right front wheel speed sensor harness; U11-left front steering light; U12-left front wheel speed sensor harness; U13-left front fog light; U14-condensing fan; U15-water tank fan; U16-left front dimmer motor; U17-left front combination lamp; U18, U19- horn (high); U20, U21- horn (low); U22-poor acceleration sensor; UA-connect to left body harness; UB1, UB2-connect to dash board harness; G03, G11, G12, G13-body ground point

Fig. 4-128 (a)

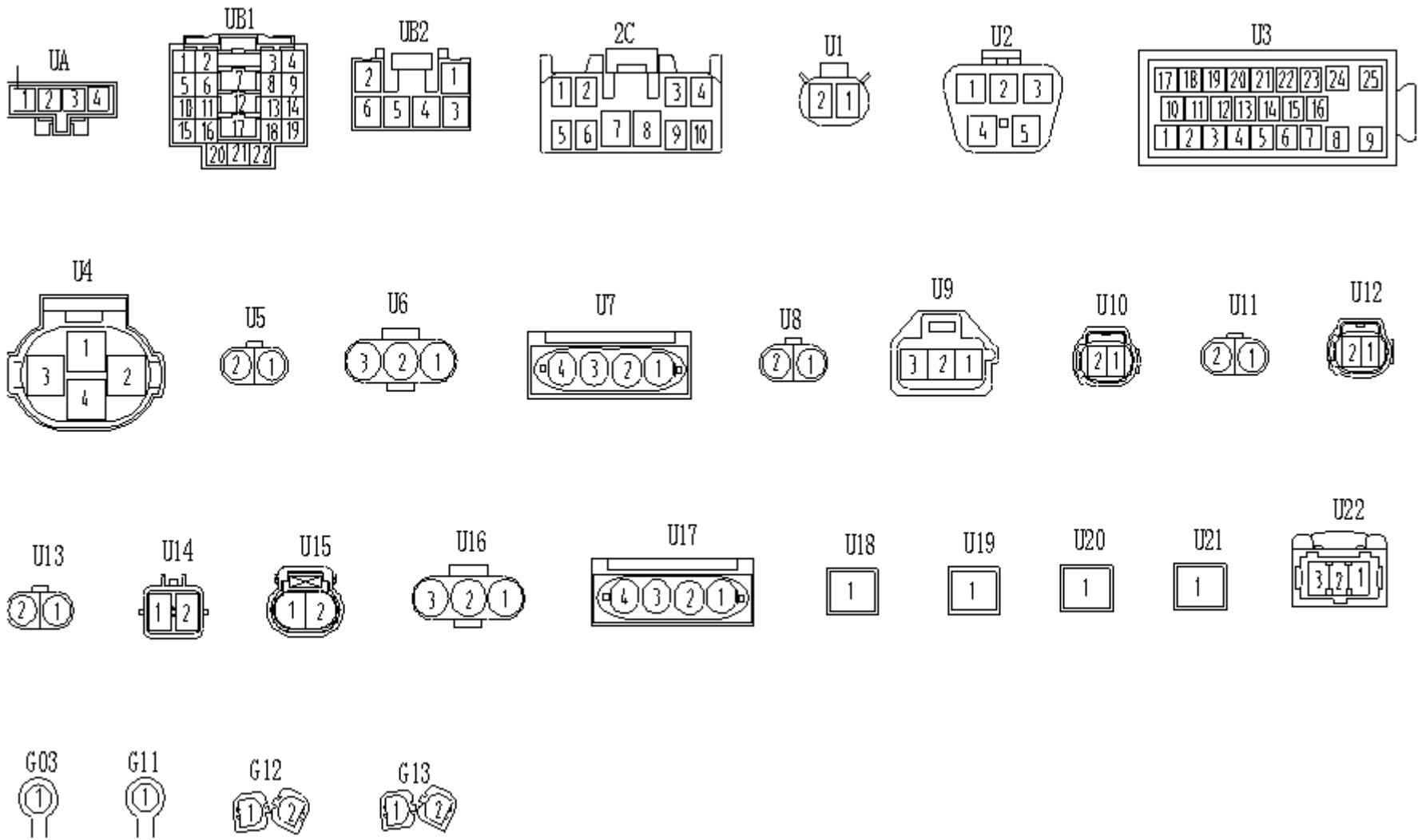
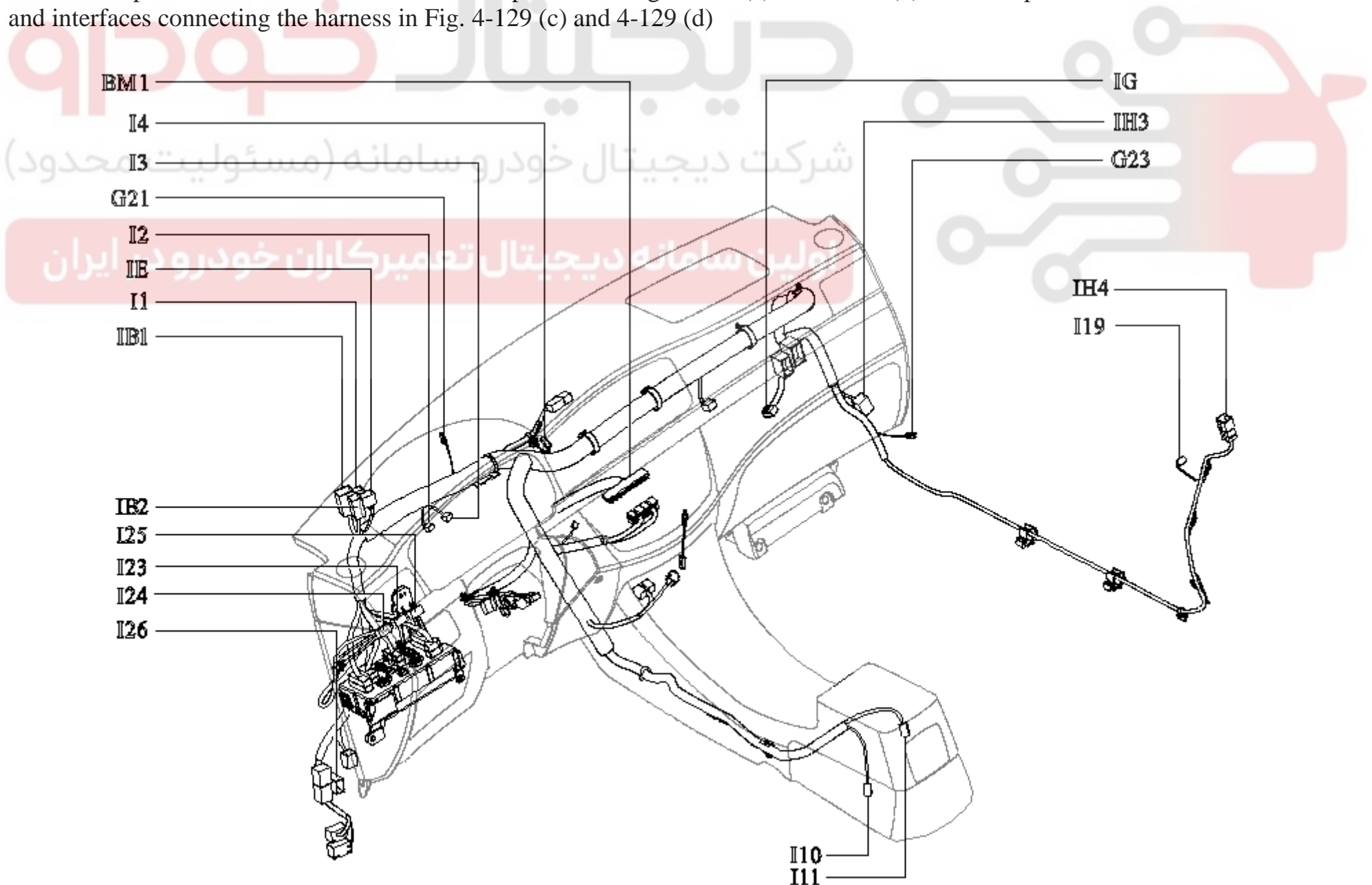

Fig. 4-128 (b)

5. Location plan for instrument harness and components in Fig. 4-129 (a) and 4-129 (b), location plan for dash board earth wire and interfaces connecting the harness in Fig. 4-129 (c) and 4-129 (d)



I1-ambient light sensor; I2-instrument cluster A; I3-instrument cluster B; I4-antenna power supply; I10-parking brake switch; I11-rear oxygen sensor; I19-right front door lamp switch; I23-electric rearview mirror switch; I24-anti-theft indicator; I25-background light regulator switch; I26-diagnostic interface; IG-A/C HNVC harness; IE-roof harness; IB1, IB2-front harness; IH3-right front door harness; IH4-connect to right rear door harness; G21-ground point; G23-body ground point; BM1-BCM body controller

Fig. 4-129 (a)

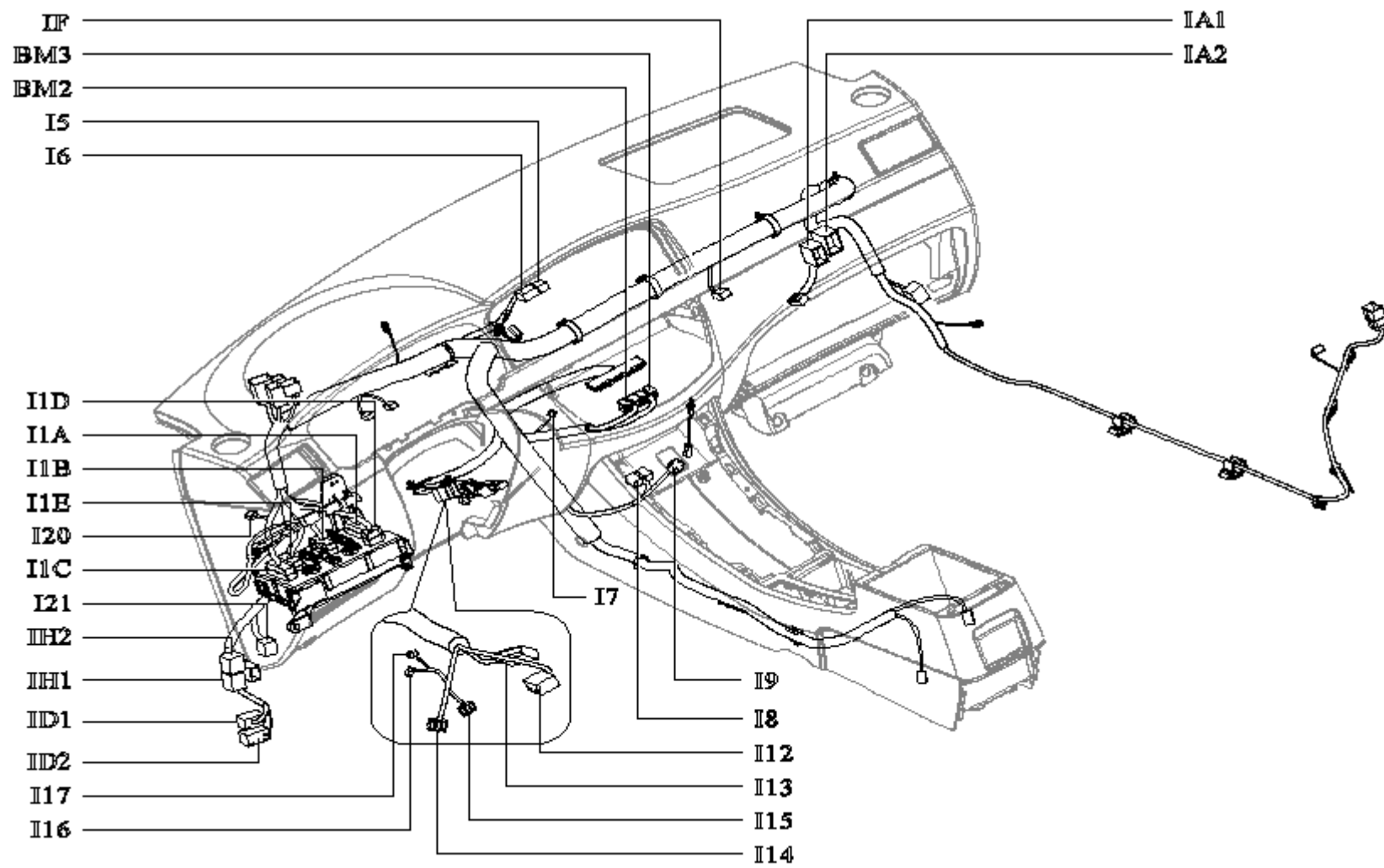

I5, I6-audio system; I7-BCM antenna; I8-cigarette lighter; I9-ashtray indicator harness; I12-ignition switch; I13-key insert switch; I14-light combination switch; I15-wiper combination switch; I16-key light ring; I17-clock spring; I20-electric capacity components; I21-brake switch; I1A, I1B, I1C, I1E-cab appliances center control box; IA1, IA2-engine harness; ID1, ID2-left body harness; IH1, IH2-left front door harness; IF-air bag harness; BM2, BM3-BCM body controller

Fig. 4-129 (b)

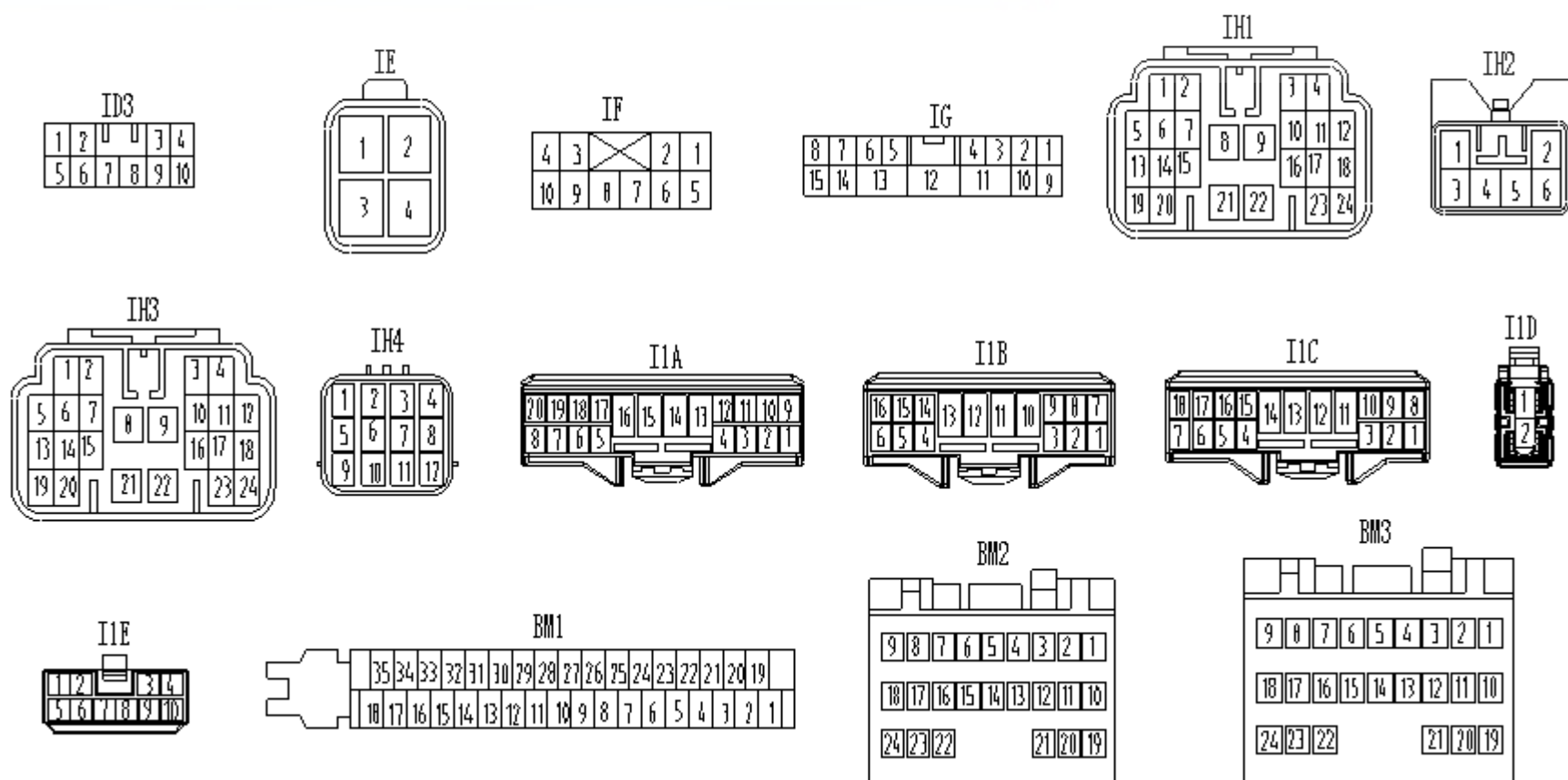
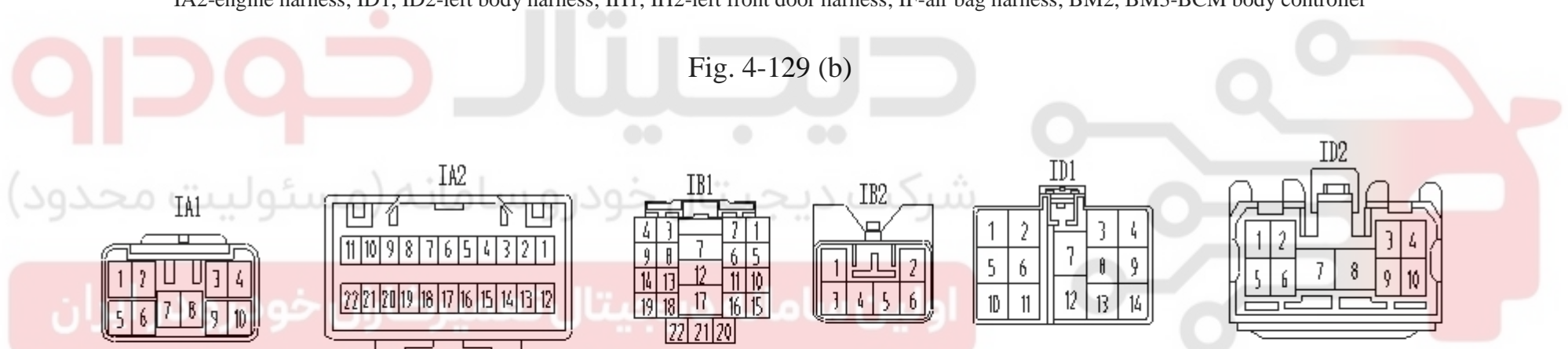

Fig. 4-129 (c)

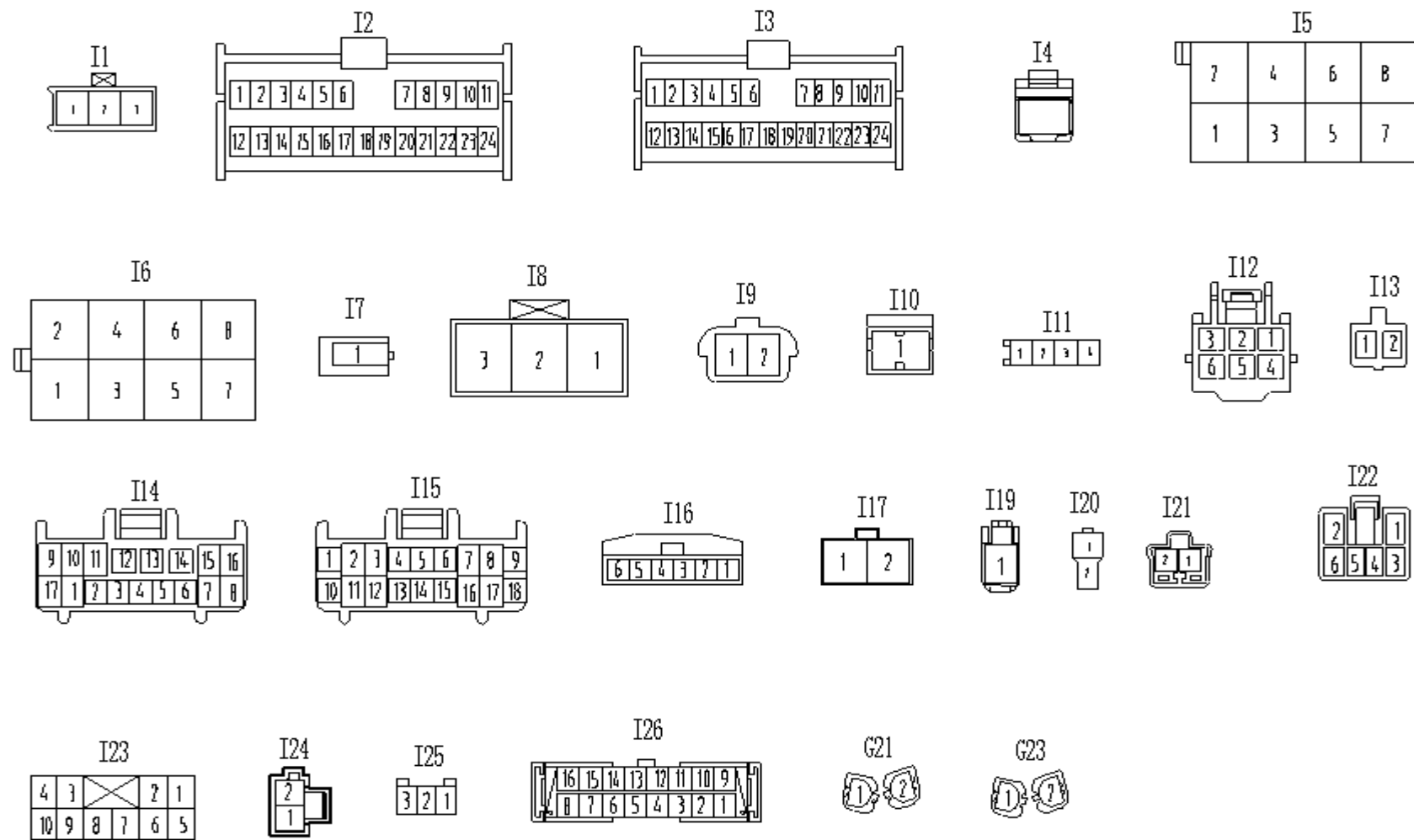
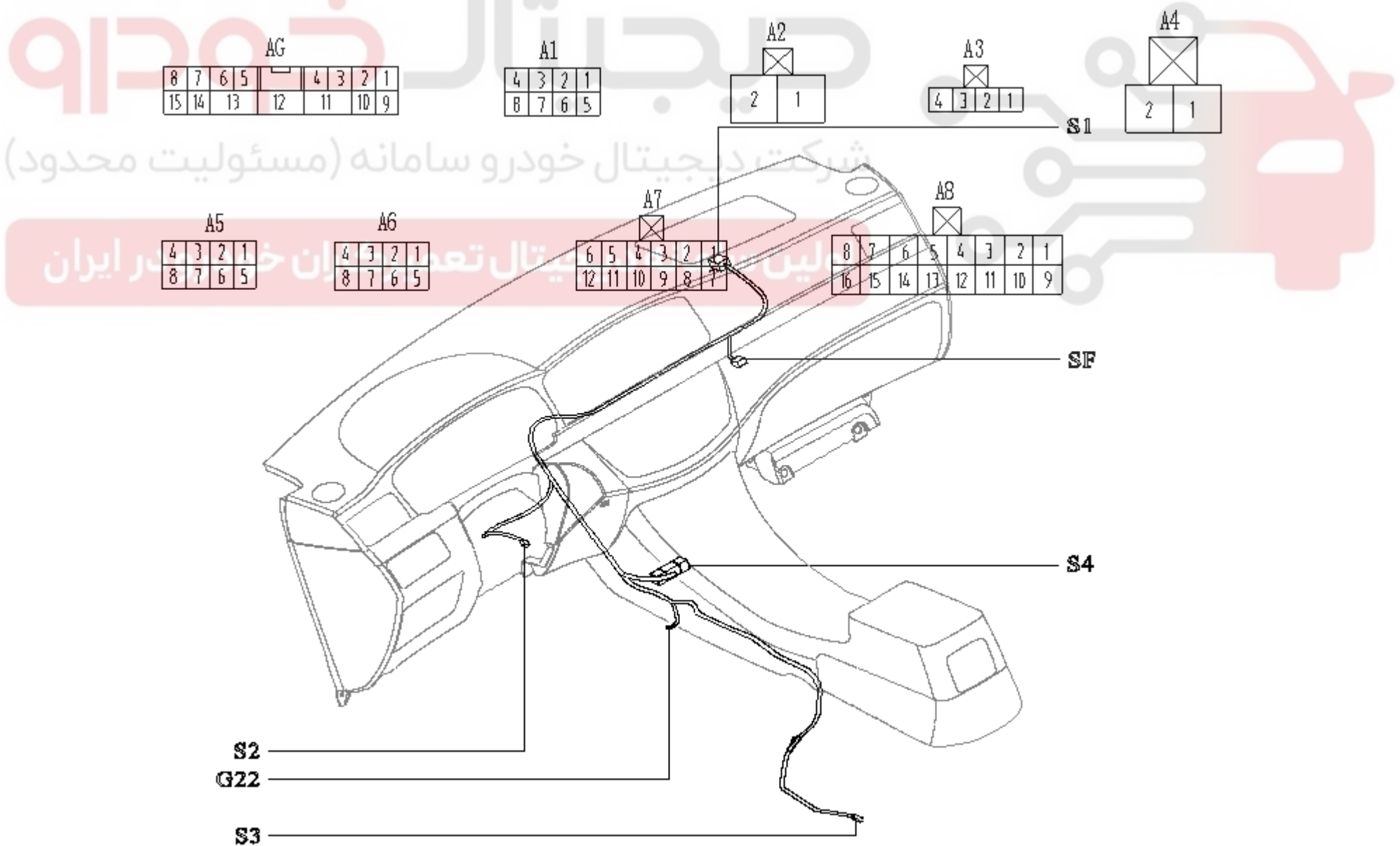

Fig. 4-129 (d)

6. Location plan for air bag harness and components in Fig. 4-130 (a), location plan for air bag, reverse radar, rear roof light, rear defrosting earth wire and interfaces connecting the harness in Fig. 4-130 (b)



SF-connect to dash board harness; S1-PAB air bag module; S2-connect to clock spring; S3-driver safety belt lock catch switch; S4-air bag ECU; G22-body ground point

Fig. 4-130 (a)

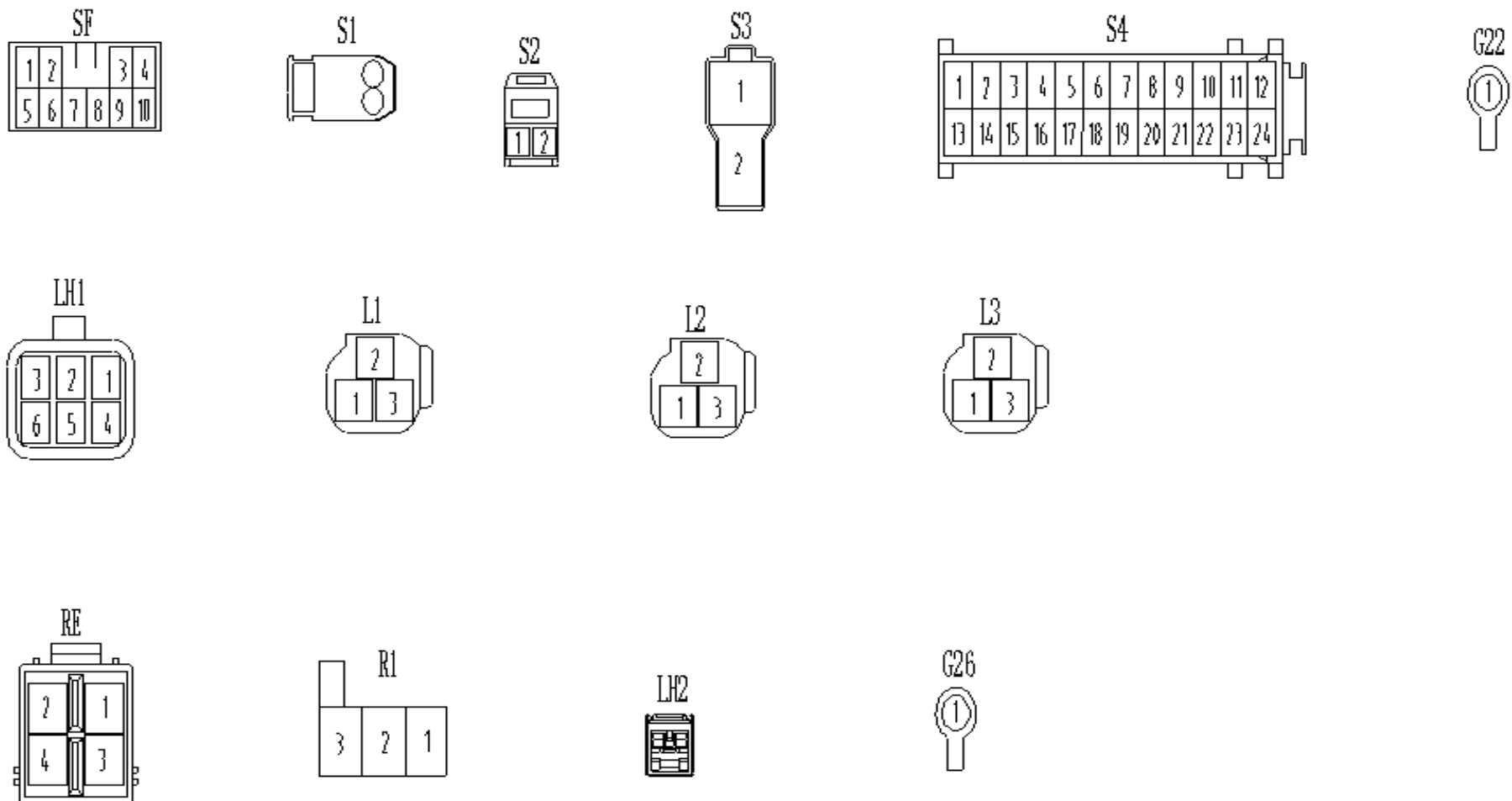

Fig. 4-130 (b)

7. Location plan for A/C HNVC earth wire and interfaces connecting the harness in Fig. 4-131

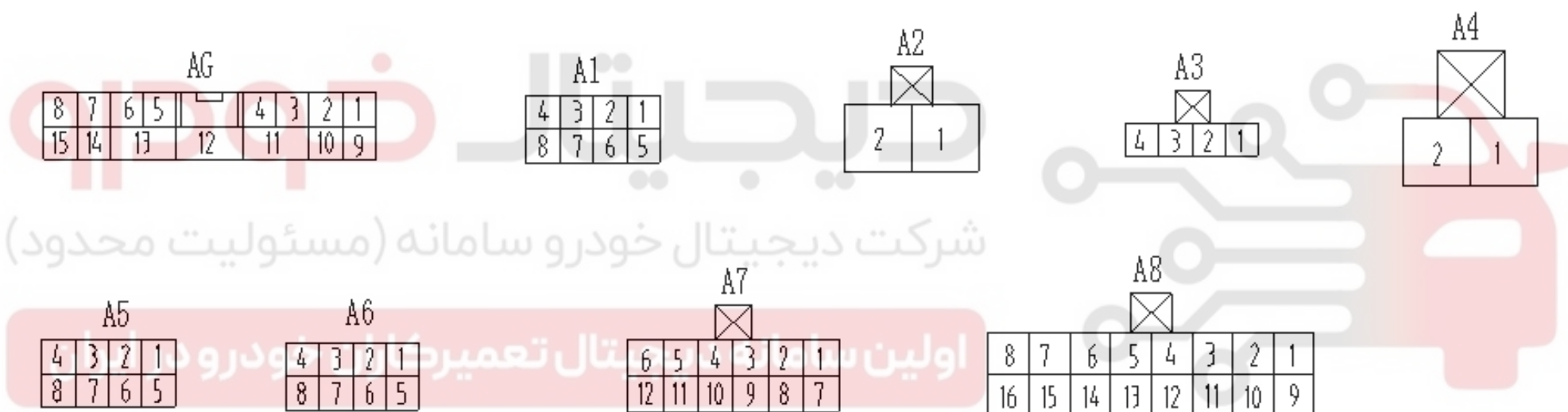

Fig. 4-131

III. Circuit diagram

1. Numbering principles

(1) The numbering of butt connector between harness assemblies

The numbering of connector is based on the harness. The S/Ns of harness and the butt connector on the harness are indicated with 3-digit or 2-digit code, e.g. when there are many butt connectors on the front compartment harness and body harness, the S/Ns are UA1, UA2...; in the contrary, the S/Ns of butt connectors on the body harness and the front compartment harness are BA1, BA2.... The first code shows which harness the connector belongs to; the first letter of English abbreviation refers to the harness; the following two codes are the same, indicating the relationship between each connector on the two butt harnesses. If there is only one butt connector there, the latter number can be omitted, and the code is indicated with 2-digit like UA or BA.

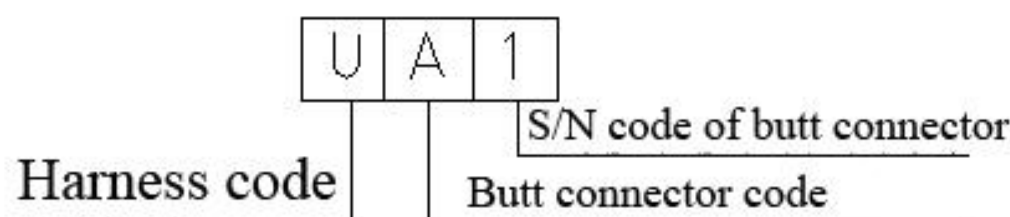

Fig. 4-132