

SECTION 8A

SEAT BELTS

CAUTION: Disconnect the negative battery cable before removing or installing any electrical unit or when a tool or equipment could easily come in contact with exposed electrical terminals. Disconnecting this cable will help prevent personal injury and damage to the vehicle. The ignition must be in B unless otherwise noted.

TABLE OF CONTENTS

| | | | |
|---|-------------|-------------------------------------|-------------|
| Specifications | 8A-2 | Maintenance and Repair | 8A-5 |
| Fastener Tightening Specifications | 8A-2 | On-Vehicle Service | 8A-5 |
| Diagnosis | 8A-3 | Front Seat Belt | 8A-5 |
| Seat Belt Warning Lamp is Inoperative | 8A-3 | Front Seat Belt Buckle | 8A-6 |
| Component Locator | 8A-4 | 2nd-Row Seat Belt | 8A-7 |
| Seat Belt Assembly | 8A-4 | 3rd-Row Seat Belt | 8A-8 |

دیجیتال خودرو

شرکت دیجیتال خودرو سامانه (مسئولیت محدود)

اولین سامانه دیجیتال تعمیرکاران خودرو در ایران



SPECIFICATIONS

FASTENER TIGHTENING SPECIFICATIONS

| Application | | N•m | Lb-Ft | Lb-In |
|-------------------|-------------------------|---------|---------|-------|
| Front Seat Belt | Adjuster Mounting Bolt | 30 - 40 | 22 - 30 | - |
| | Retractor Mounting Bolt | 30 - 45 | 22 - 33 | - |
| | Upper Bolt | 30 - 45 | 22 - 33 | - |
| | Lower Bolt | 30 - 45 | 22 - 33 | - |
| | Belt Buckle Bolt | 30 - 45 | 22 - 33 | - |
| 2nd-Row Seat Belt | Retractor Mounting Bolt | 30 - 45 | 22 - 33 | - |
| | Upper Bolt | 30 - 45 | 22 - 33 | - |
| 3rd-Row Seat Belt | Upper Bolt | 30 - 45 | 22 - 33 | - |
| | Lower Bolt | 30 - 45 | 22 - 33 | - |
| | Retractor Bolt | 30 - 45 | 22 - 33 | - |

دیجیتال خودرو

شرکت دیجیتال خودرو سامانه (مسئولیت محدود)

اولین سامانه دیجیتال تعمیرکاران خودرو در ایران



DIAGNOSIS

SEAT BELT WARNING LAMP IS INOPERATIVE

| Condition | Probable Cause | Correction |
|---------------------------------------|---|--------------------------------|
| Seat belt warning lamp is inoperative | Seat belt warning lamp wiring harness is open circuit or a short circuit. | Repair the wiring harness. |
| | The continuity between the two terminals at the switch side of the connector is fail. | Replace the seat belt switch. |
| | The continuity between the terminal for the BLK wire and ground is fail. | Repair the open ground. |
| | The warning lamp bulb in the instrument cluster is blown. | Replace the warning lamp bulb. |

دیجیتال خودرو

شرکت دیجیتال خودرو سامانه (مسئولیت محدود)

اولین سامانه دیجیتال تعمیرکاران خودرو در ایران



COMPONENT LOCATOR

SEAT BELT ASSEMBLY

[Front Seat Belt]

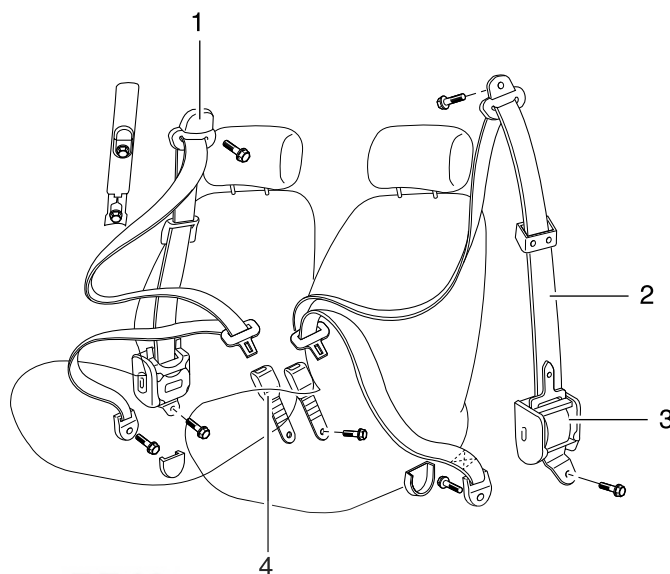

[Rear Seat Belt]

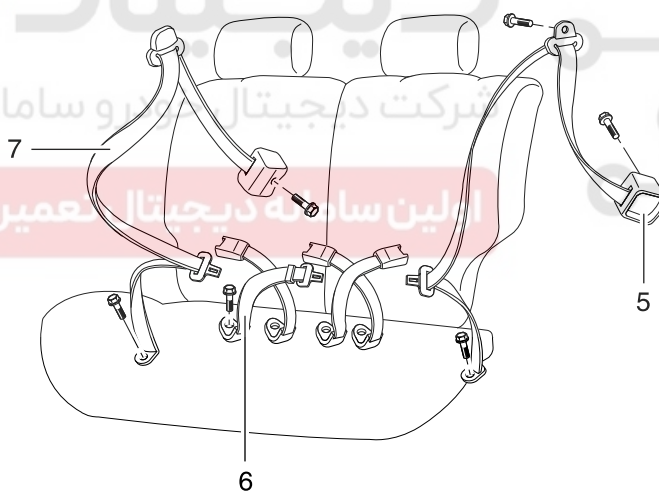

YAD8A010

- 1 Upper anchor plate
- 2 Seat Belt
- 3 Retractor
- 4 Buckle

- 5 Retractor
- 6 Rear Seat Belt
- 7 Seat Belt

MAINTENANCE AND REPAIR

ON-VEHICLE SERVICE

FRONT SEAT BELT

Removal Procedure

1. Push to slide the front seat toward and push down the seatback.
2. Pry off the bolt cap of the seat belt and remove the lower bolt.
3. Pry off the upper bolt cap using the special tool and remove the upper bolt.
4. Pry off the lower B-pillar trim.
5. Disconnect the connector in the front seat belt retractor and remove the mounting bolt.
6. Separate the front seat belt and the retractor assembly.

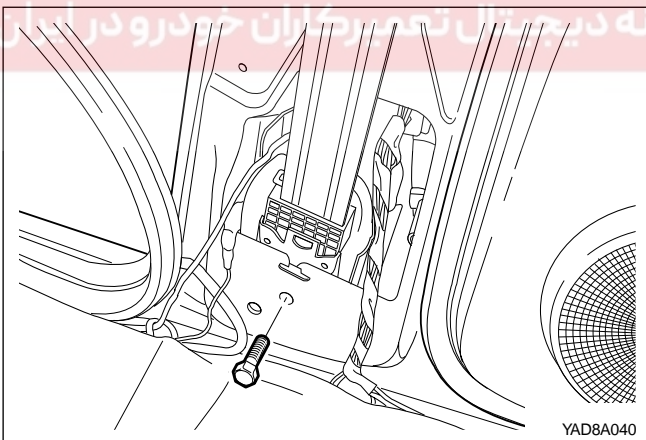
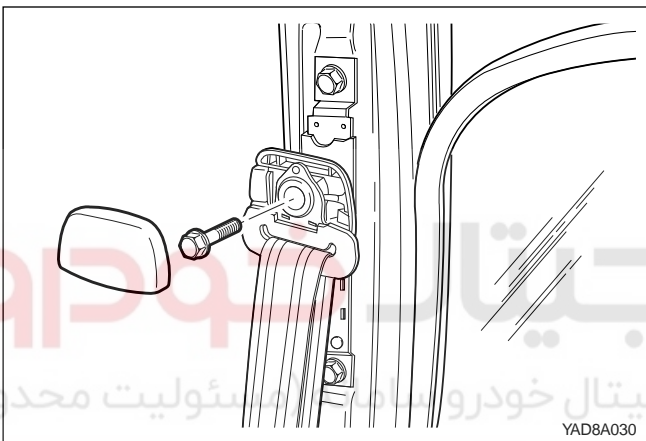
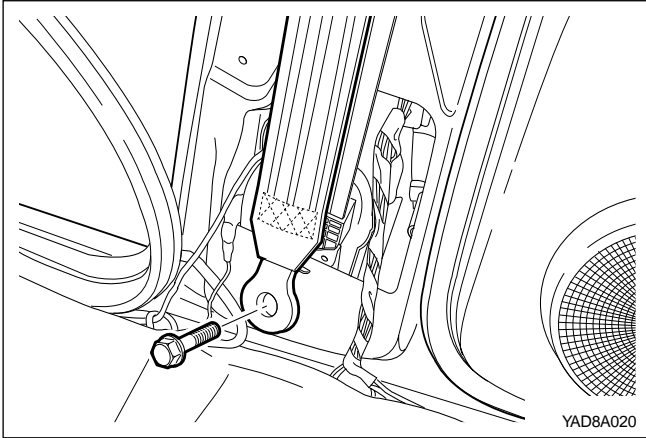

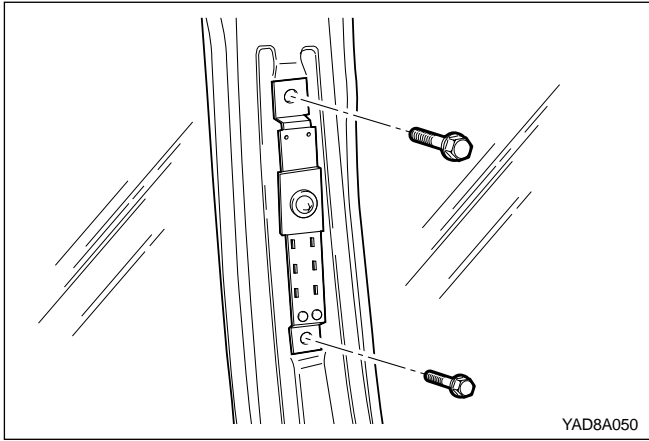

7. Remove the upper B-pillar trim and remove the bracket mounting bolt of the height adjuster to remove the adjuster assembly.

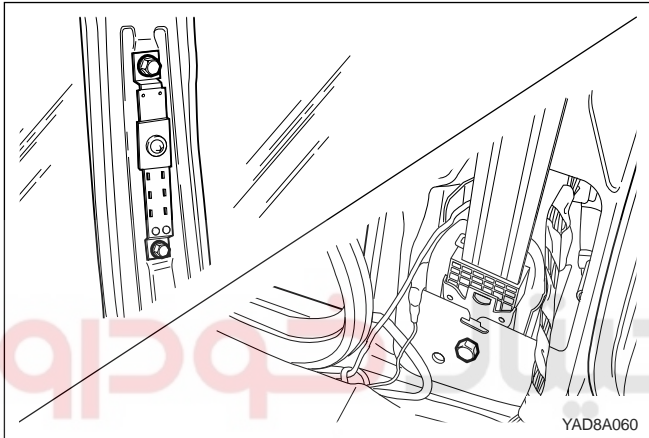

Installation Procedure

1. Tighten the adjuster and the seat belt retractor bolt as specified torque.

Installation Notice

| | |
|-----------------------------|--------------------------------|
| Adjuster Mounting Bolt (1) | 30 - 40 N•m (22 - 30 lb-ft) |
| Retractor Mounting Bolt (2) | 30 - 45 N•m (22 - 33 lb-ft) |



2. Tighten the upper/lower bolt as specified torque.

Installation Notice

| | |
|----------------|--------------------------------|
| Upper Bolt (1) | 30 - 45 N•m (22 - 33 lb-ft) |
| Lower Bolt (2) | 30 - 45 N•m (22 - 33 lb-ft) |

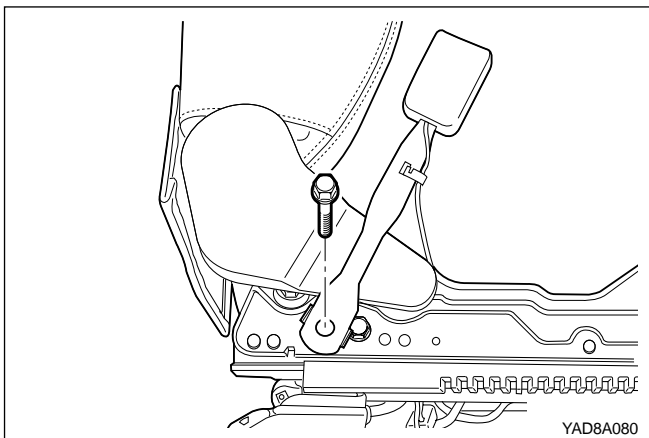

FRONT SEAT BELT BUCKLE

Removal and Installation Procedure

1. Remove the seat and seat belt buckle mounting bolt to remove the buckle assembly.

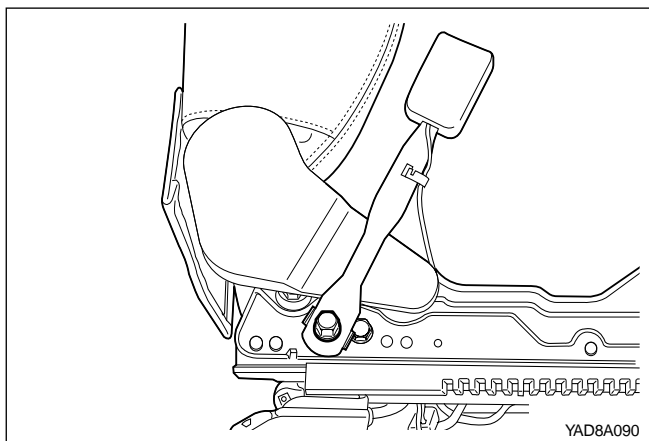

- Installation should follow the removal procedure in the reverse order. Tighten the mounting bolt as specified torque.

Installation Notice

| | |
|-------------------|--------------------------------|
| Tightening Torque | 30 - 45 N•m (22 - 33 lb-ft) |
|-------------------|--------------------------------|

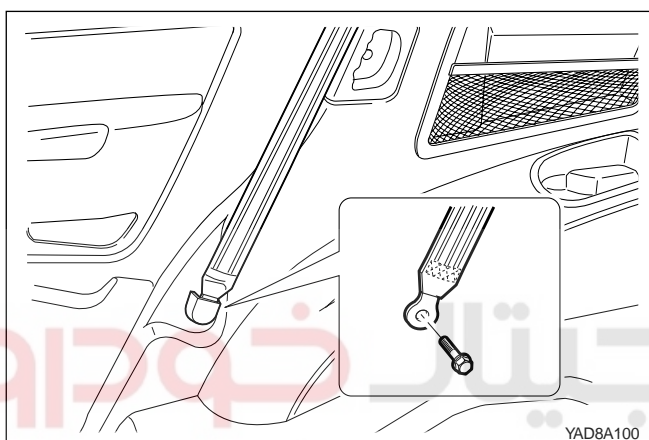

2ND-ROW SEAT BELT

Removal and Installation Procedure

- Pry off the lower bolt cap of the seat belt and remove the lower bolt.

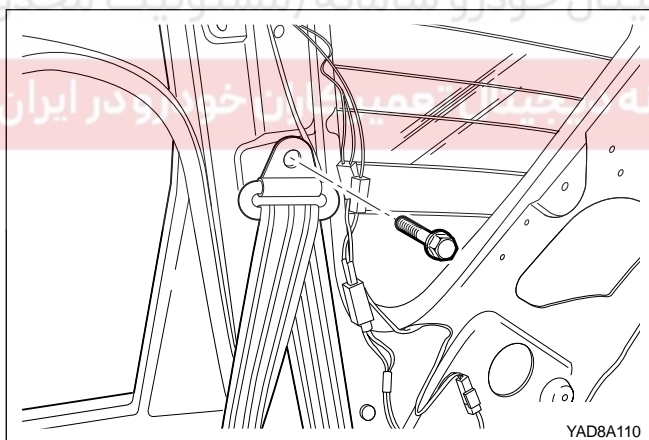

- Remove the lower quarter trim.
- Remove the upper quarter trim.

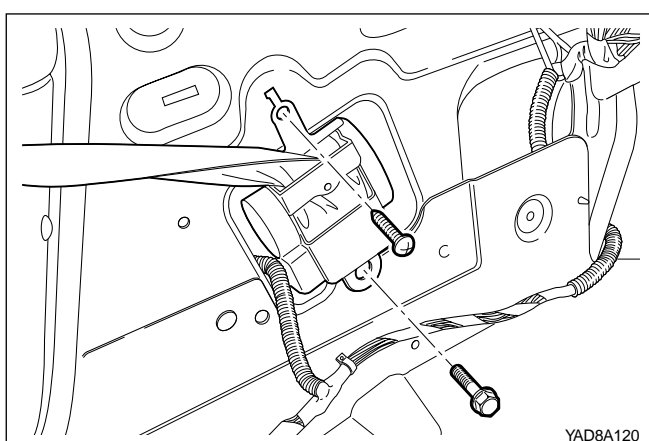

- Remove the seat belt upper bolt.
- Remove the retractor bolt and screw. Remove the seat belt assembly.

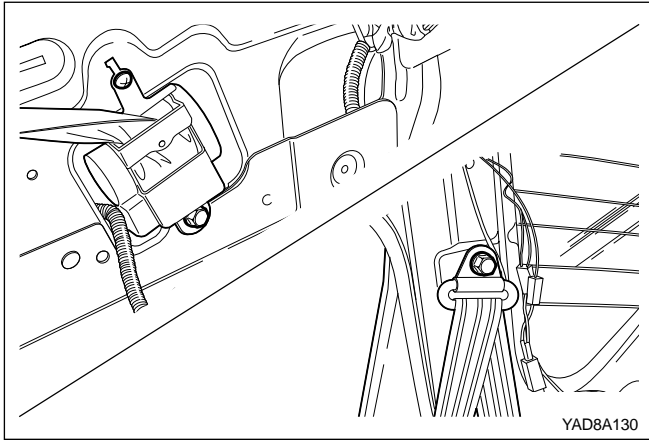

6. Installation should follow the removal procedure in the reverse order.

- Tighten the seat belt retractor bolt and the upper bolt as specified torque.

Installation Notice

| | |
|-----------------------------|--------------------------------|
| Retractor Mounting Bolt (1) | 30 - 45 N•m (22 - 33 lb-ft) |
| Upper Bolt (2) | 30 - 45 N•m (22 - 33 lb-ft) |

- Tighten seat belt lower bolt as specified torque.

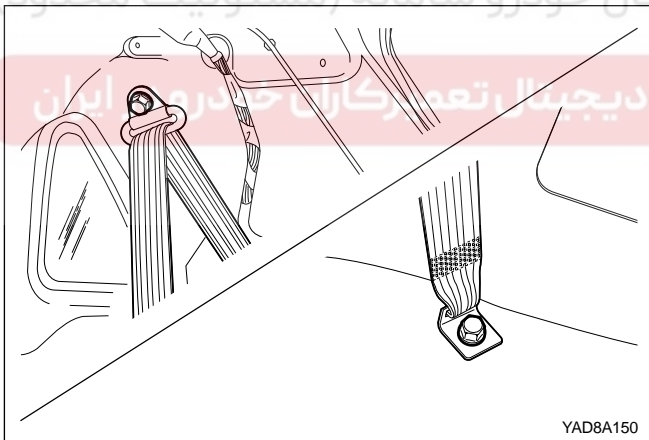
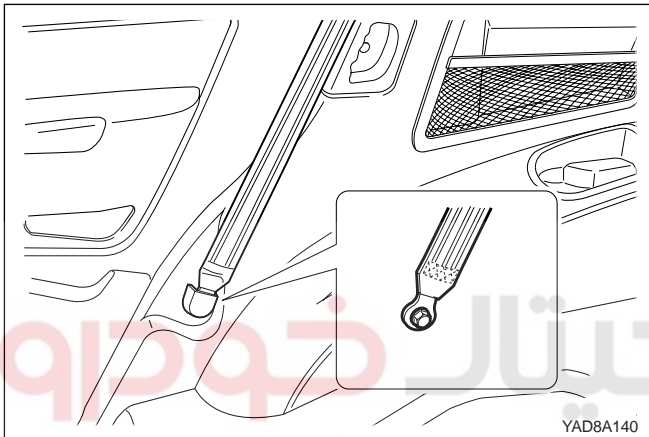

3RD-ROW SEAT BELT

Removal and Installation Procedure

1. Remove the upper/lower bolt of the seat belt.

Notice: Push the 3rd row seat down and perform the work with the upper quarter trim removed.

2. Remove the retractor bolt and screw of the 3rd row seat and then remove the seat belt assembly.

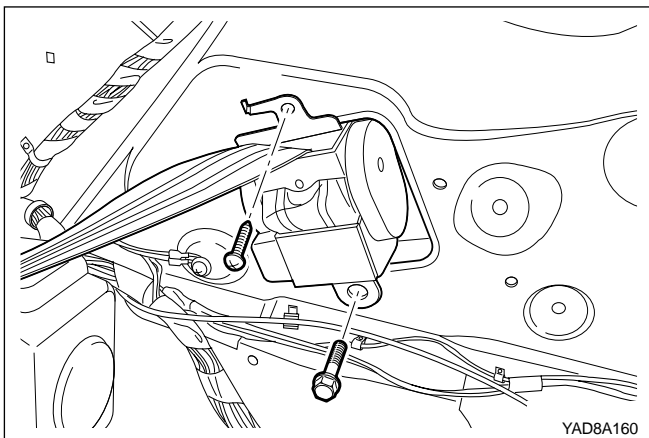

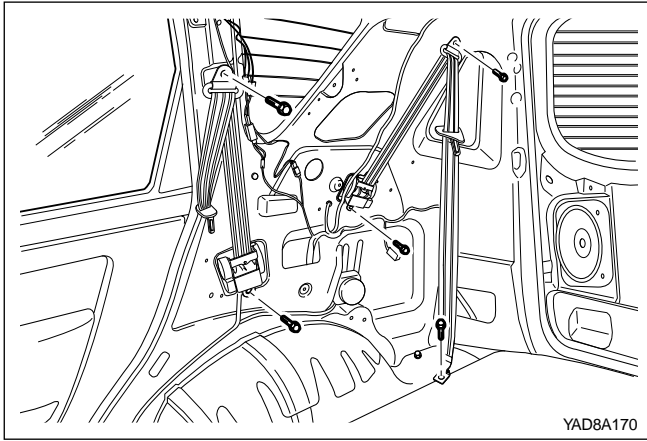

3. Installation should follow the removal procedure in the reverse order. Tighten each bolt as specified torque.

Installation Notice

| | |
|--------------------|--------------------------------|
| Upper Bolt (1) | 30 - 45 N•m (22 - 33 lb-ft) |
| Lower Bolt (2) | 30 - 45 N•m (22 - 33 lb-ft) |
| Retractor Bolt (3) | 30 - 45 N•m (22 - 33 lb-ft) |

دیجیتال خودرو

شرکت دیجیتال خودرو سامانه (مسئولیت محدود)

اولین سامانه دیجیتال تعمیرکاران خودرو در ایران

